

Block of the Month April Sunshine pinwheel and tree

Welcome to the Block of the Month for April. With this block, we are halfway to completing the mystery quilt. If you haven't started yet, this is a fun block to get you going.

Happy sewing, Roxy

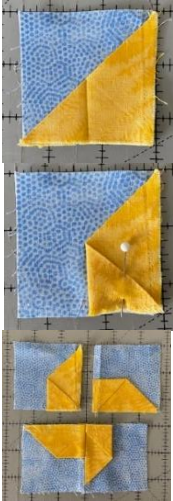

Fabric needed for sunshine:

Color 1: four 2 ½" x 2 ½" squares.

Color 2 (pinwheel): four 2 ½" x 2 ½" squares.

Background: one 4 ½" x 2" rectangle.

Fold the pinwheel (color 2) squares in half diagonally and iron.

Lay the folded triangle on top of the color 1 fabric, raw edges together. The folded side will be diagonal on the color 1 square.

Taking one point on the triangle, fold it down and pin it in place.

Repeat with the other 3 squares. Pay attention to which point you fold down. You want to make sure all are going the same way or your pinwheels won't spin.

Lay the block out and sew together to form a four patch. The center seam will be bulky so twirl the back seams and iron flat.

Sew a background strip 4 ½" x 2" to the top.



Fabric Needed for small tree.

One 4 ½ x 5" green for top of tree; one 1 ½" x 3 ½" brown for trunk.

Background: Four 1 ½" squares to snowball corners, two 2" x 3 ½" strips for sides of trunk and one 4 ½" x 6 ½" rectangle.

Snowball the corners of the green tree top, trim and press back.

Sew a background strip to the left & right of the tree trunk.

Sew the trunk to the tree top.

Sew a background strip 4 ½" x 6 ½" to the top of the tree section.



Line up the sunshine and tree vertically and sew together.

This block should measure 4 ½" x 20 ½",